

**Flanged 45° Angle Branch (Class K14)**

Nominal Bore		Dimensions		Weight	
				Epoxy Kgs.	Lined Kgs
mm	Type	L mm	H mm		
80	N	500	375	21	22
100	N	540	405	27	29
150	N	640	480	47	50
200	N	735	560	71	76
250	N	830	640	105	111
300	N	930	715	147	156
350	M	880	790	168	185
400	M	970	870	205	220
450	M	1060	950	277	297
500	M	1140	1025	353	373
600	M	1310	1180	541	578

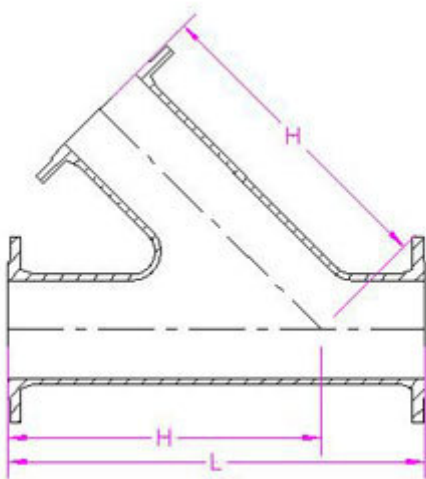

**Type N**

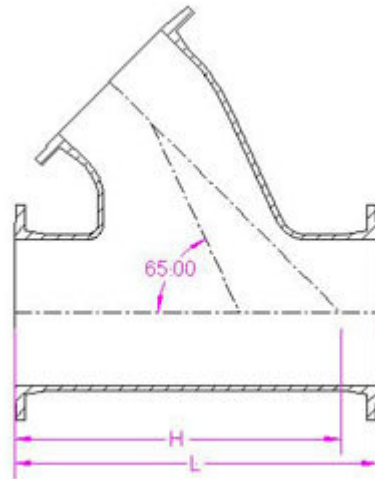

**Type M**